



**ASY-01-034 – NCA-2  
Product Installation Document**

21/01/2013 REV: 1.00

DOC-03-063 ECN12-0046

## 1 Product Overview

This installation Document describes how to mount the NCA-2 Assembly using the supplied brackets.

## 2 Installation

1. Align mounting holes on brackets with appropriate mounting holes on NCA-2.
2. Use the four supplied screws to fasten the brackets to the NCA-2 as shown.
3. Mount the NCA-2 in compatible dress panel.

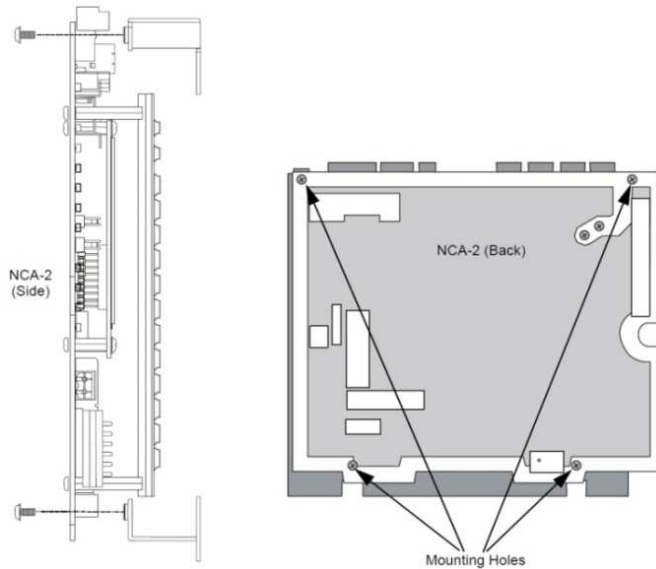

Figure 1



**NOTE:** Some switches and connectors will not be accessible after mounting. Configure prior to mounting.

## 3 Components

Part No.	Description	Qty
DOC-03-063	NCA-2 Install Sheet	1
FG-29-016	NCA-2 - Network Control Annunciator, Master node for Noti-Fire-Net	1
MW-02-039	NCA-2 Mounting Brackets (APO Grey)	1
10313	Nut-Whizlock Nut, M3 Flanged Nut	4

Table 1: Components